

# POTENTIAL CONTAMINANT SOURCES

- 1. Gas/Service Station
- 2. Individual Wells
- 3. Irrigation
- 4. Septic Tanks
- 5. Pesticide & Fertilizer

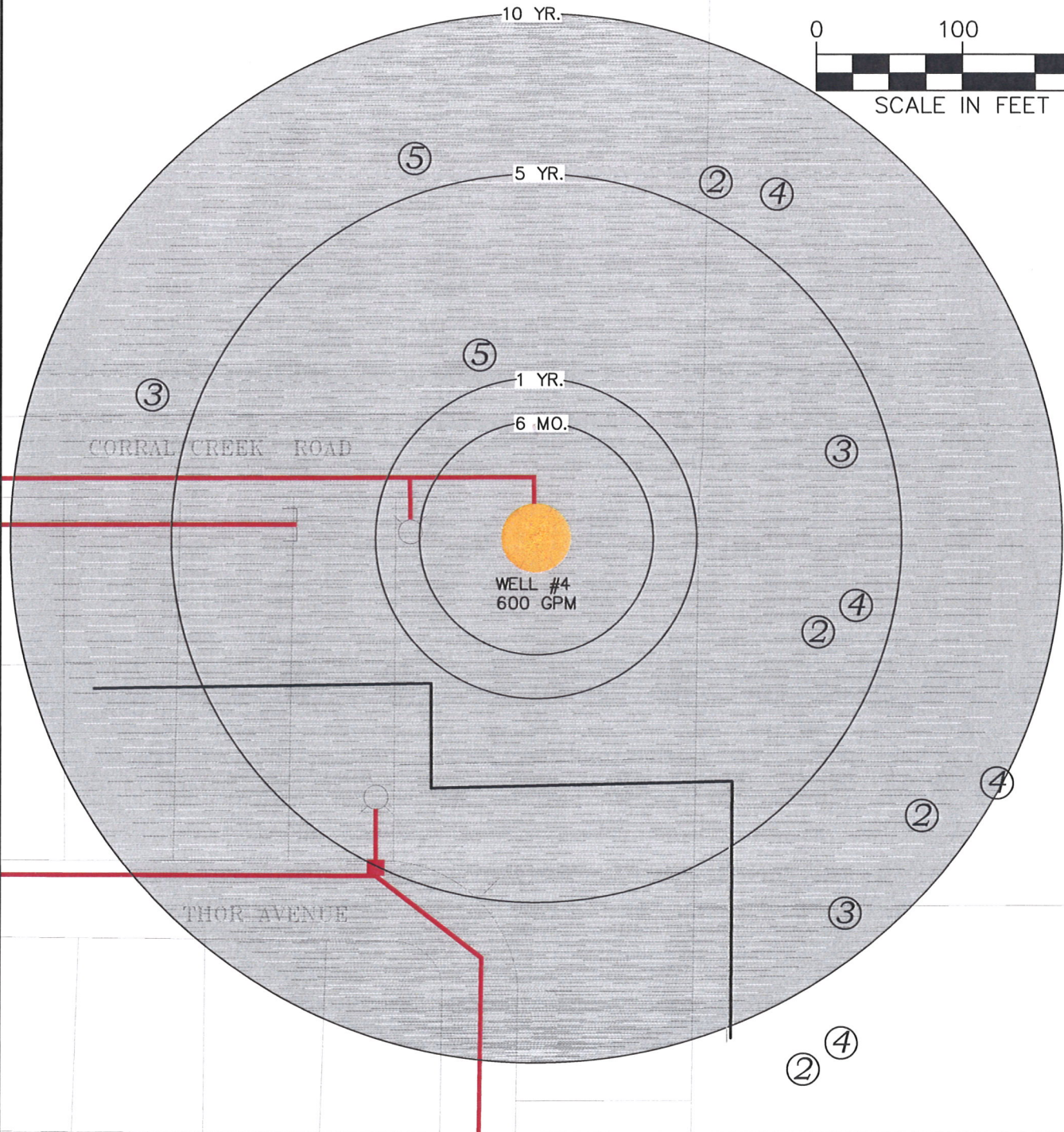
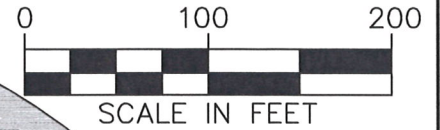

**SPINK**  
ENGINEERING

1045 Jadwin Ave., Suite E  
 Richland, WA  
 509.946.1581  
 www.spinkeng.com

*BENTON CITY*  
**WELL #4**  
 NOVEMBER 2017